

ER50-2100

ER50-2100,
Maxium payload 50 kg with maxium reach 2146 mm.

- Highlights**
Thanks to the high stiffness structure, with high-speed intelligent palletizing application software, the takt is improved by 20%, bring customers more efficiency;
Multiple specific application software could be integrated, with soft PLC and a variety of field bus interface, which enable customers easily face various application challenges;
High performance collision detection function helps safety realization.

- Applications**
It can be used in grinding, polishing, handling operations, palletizing, etc.

- Industries**
Suitable for auto parts, photovoltaic, food and beverage, building materials, logistics and warehousing and other industries.



EFORT Intelligent Robot Co., Ltd.
PHONE: (00 86) 400-052-8877
ADDRESS: No. 96, Wanchun East Road, Wuhu, China
(Anhui) Pilot Free Trade Zone
WWW.EFORT.COM.CN

EFORT

SPECIFICATIONS

Model		ER50-2100
Type		Articulated
Controlled axes		6 Axes
Max. payload on wrist		50 kg
Repeatability		±0.06 mm
Robot weight		610 kg
Reach		2146 mm
Robot IP grade		IP54/IP67 (Wrist)
Cabinet IP grade		IP54
Drive mode		AC servo drive
Installation		Floor
Installation enviroment	Ambient temperature	0~45 °C
	Ambient humidity	RH≤80% (No dew nor frost allowed)
	Vibration acceleration	4.9 m/s ² (<0.5 G)

Allowable load moment at wrist	J4	182 N·m
	J5	182 N·m
	J6	120 N·m
Allowable load inertia at wrist	J4	12.68 kg·m ²
	J5	12.68 kg·m ²
	J6	10 kg·m ²
Maximum speed	J1	170°/sec
	J2	170°/sec
	J3	170°/sec
	J4	270°/sec
	J5	270°/sec
	J6	365°/sec
Motion range	J1	±180°
	J2	+70°-130°
	J3	+175°-80°
	J4	±360°
	J5	±115°
	J6	±450°

OPERATING SPACE

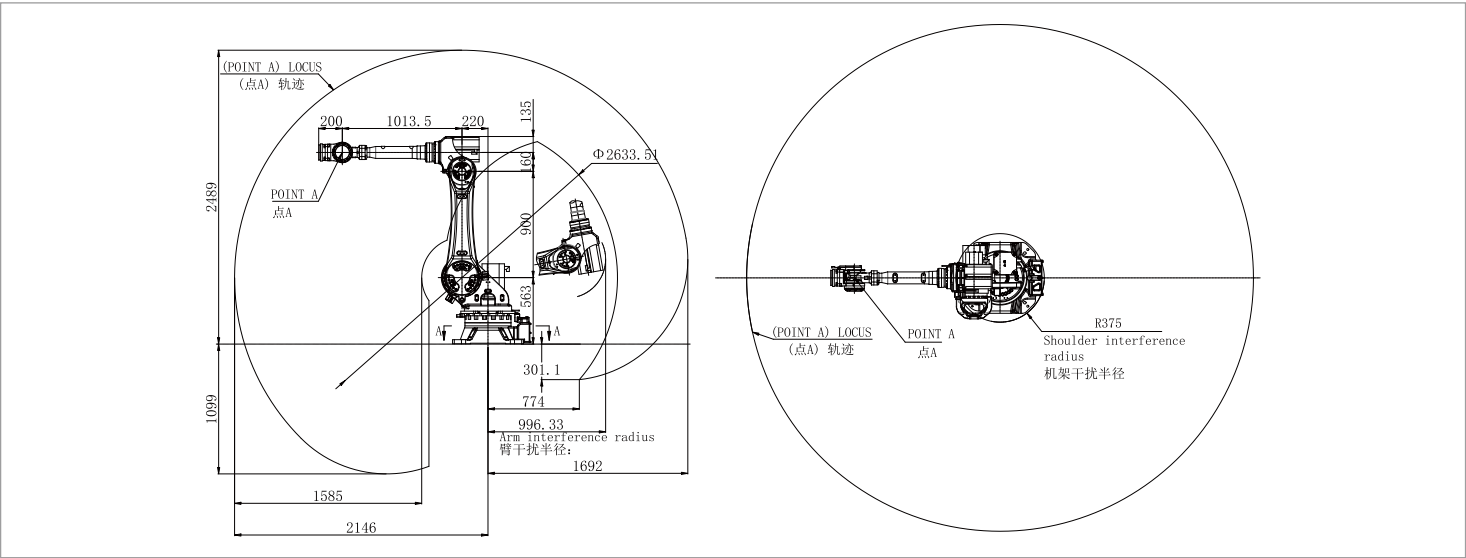

BASE MOUNTING SIZE

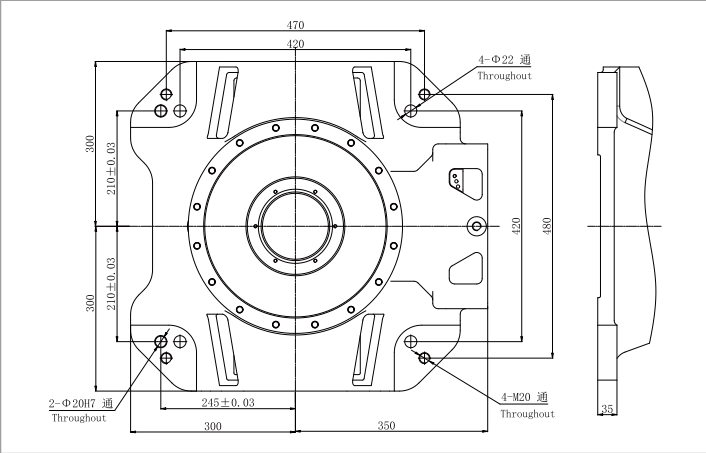

END FLANGE MOUNTING SIZE

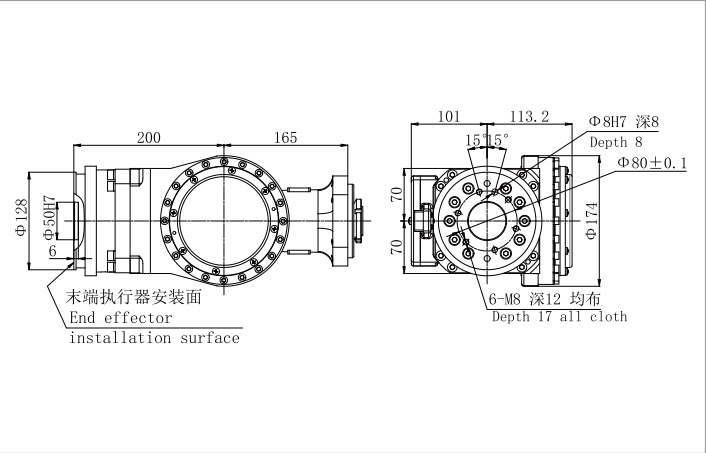

*The final interpretation right belongs to EFORT Intelligent Robot Co., Ltd. Any updates will be made without prior notice.